

Rigid Lance Holders

20K Lance Holder

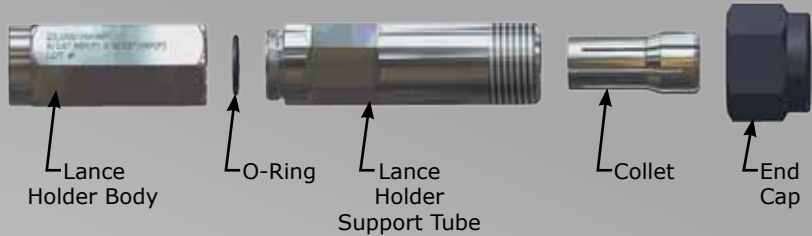
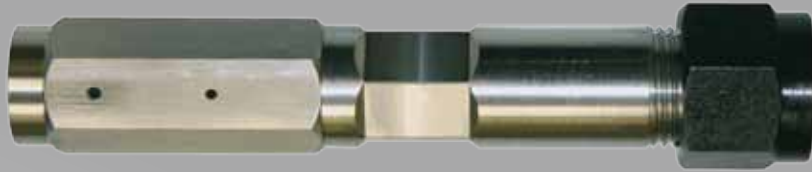

The threaded end of a rigid lance where it connects directly to a manifold is its weakest point. A break at this threaded connection renders an otherwise good lance unusable.

The **Advanced Pressure Systems Rigid Lance Holder** provides full support to the lance at a point well in front of the thread. This Lance Holder is designed to be the best available on the market. It uses a collet and lock nut of the same design as used for a machine shop lathe, which provides a vise like grip on the lance, completely relieving stress on the thread.

Installation or removal of the lance is very easily accomplished: Simply slide the End Cap, Collet and Lance Holder Support Tube onto the lance in that order and then screw the lance into the Lance Holder body. The Lance Holder Tube is then screwed into the Body and then the Collet is secured into the Lance Holder Tube by the End Cap. The lance will then be fully supported.

15K Lance Holder



Part #	15K Lance Holders Description	PSI/Bar
20-002-001	Lance Holder Assy. 1/2" NPT (M) x 1/16" NPT (F)	15K/1034
20-002-002	Lance Holder Assy. 1/2" NPT (M) x 1/8" NPT (F)	15K/1034
20-002-003	Lance Holder Assy. 1/2" NPT (M) x 1/4" NPT (F)	15K/1034

Part #	20K Lance Holders Description	PSI/Bar
21-030-001	Lance Holder Assy. 9/16" MP (F) x 1/4"-28 RH (F)	20K/1379
21-030-002	Lance Holder Assy. 9/16" MP (F) x 3/8"-24 RH (F)	20K/1379
21-030-003	Lance Holder Assy. 9/16" MP (F) x 9/16"-18 RH (F)	20K/1379
21-030-004	Lance Holder Assy. 9/16" MP (F) x 1/4"-28 LH (F)	20K/1379
21-030-005	Lance Holder Assy. 9/16" MP (F) x 3/8"-24 LH (F)	20K/1379
21-030-006	Lance Holder Assy. 9/16" MP (F) x 9/16"-18 LH (F)	20K/1379

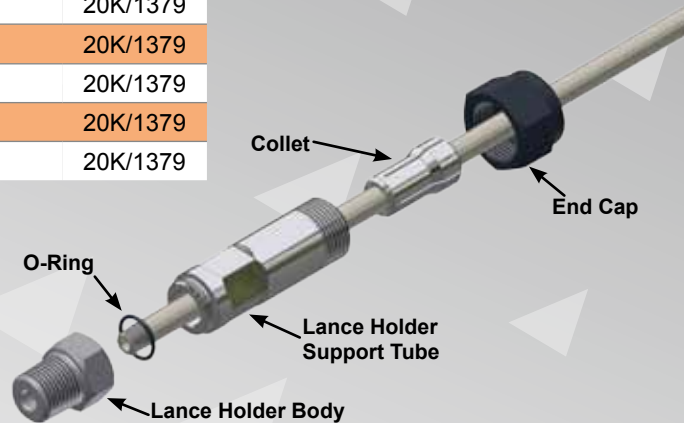

www.advancedpressuresystems.com

Toll Free in North America: 1 (877) 290-4277 or (281) 290-9950